

**BATTERY SAFETY INFORMATION:**

Batteries are small objects. Replacement of batteries must be done by adults. Follow the polarity (+/-) diagram in the battery compartment. Promptly remove dead batteries from the toy. Dispose of used batteries properly. Remove batteries for prolonged storage. Only batteries of the same or equivalent type as recommended are to be used. DO NOT incinerate used batteries. DO NOT dispose of batteries in fire, as batteries may explode or leak. DO NOT mix old and new batteries or types of batteries (i.e. alkaline/standard/rechargeable). Using rechargeable batteries is not recommended due to possible reduced performance. Rechargeable batteries are only to be charged under adult supervision. Replaceable-rechargeable batteries are to be removed from the toy before being charged. DO NOT recharge non-rechargeable batteries. DO NOT short-circuit the supply terminals.

NOTE: Always use fresh, premium quality batteries.



• Requires 2 x 1.5 V AAA (LR03) batteries (included). Batteries or battery packs must be recycled or disposed of properly. When this product has reached the end of its useful life, it should not be disposed of with other household waste. The Waste Electrical and Electronic Equipment Regulations require it to be separately collected so that it can be treated using the best available recovery and recycling techniques. This will minimize the impact on the environment and human health from soil and water contamination by any hazardous substances, decrease the resources required to make new products and avoid using up landfill space. Please do your part by keeping this product out of the municipal waste stream! The "wheelie bin" symbol means that it should be collected as "waste electrical and electronic equipment". You can return an old product to your retailer when you buy a similar new one. For other options, please contact your local council.

**IMPORTANT INFORMATION:** Remove all packaging before use. Retain this information, addresses and phone numbers for future reference. Content may vary from pictures. An adult should periodically check this toy to ensure no damage or hazards exist, if so, remove from use. Children should be supervised during play. Spin Master Ltd. reserves the right to discontinue use of the [www.pawpatrol.com/videos](http://www.pawpatrol.com/videos) website at any time.

SPIN MASTER LTD., 225 KING STREET WEST, TORONTO, ON M5V 3M2 CANADA  
 Imported into EU by / Importé dans l'UE par: Spin Master International B.V., Kingsfordweg 151,  
 1043 GR Amsterdam, The Netherlands  
[www.spinmaster.com](http://www.spinmaster.com)  
 Imported by / Importé par Spin Master Australia Pty Ltd, 18-24 Chandos Street, St Leonards,  
 NSW 2065 ☎ 1800 316 982  
[www.spinmaster.com](http://www.spinmaster.com)



Meets CPSC safety requirements.

TM Spin Master Ltd. All rights reserved. ©2018 Spin Master PAW Productions Inc. Nickelodeon and all related titles and logos are trademarks of Viacom International Inc.

MADE IN VIETNAM



## INSTRUCTION GUIDE

3+  
Years



How To Videos available at

[www.pawpatrol.com/howtovideos](http://www.pawpatrol.com/howtovideos)

### CONTENTS

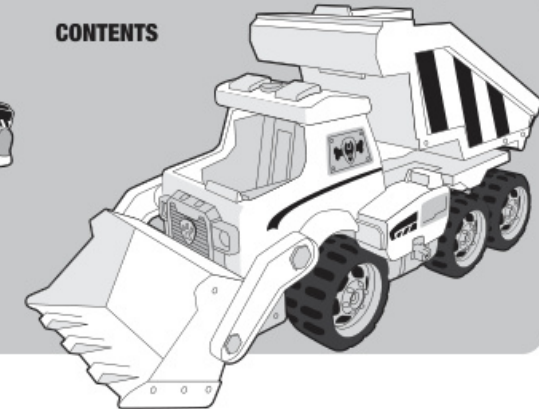

# ULTIMATE CONSTRUCTION TRUCK™

Check out our YouTube Channel for more  
 PAW Patrol Content at  
[www.youtube.com/user/OfficialPawPatrol](http://www.youtube.com/user/OfficialPawPatrol)



NORTH AMERICA – 1-800-622-8339,  
 1-800-622-8339, [customercare@spinmaster.com](mailto:customercare@spinmaster.com)  
 UK – 0800 206 1191, [serviceuk@spinmaster.com](mailto:serviceuk@spinmaster.com)  
 IRELAND – 1800 992 249  
 AUSTRALIA – 1800 316 982, [customercare@spinmaster.com](mailto:customercare@spinmaster.com)

[WWW.SPINMASTER.COM](http://WWW.SPINMASTER.COM)



2 x AAA (LR03) 1.5 V  
 1.5 V  
 Included

**WARNING:**  
 CHOKING HAZARD – Small parts.  
 Not for children under 3 years.



T16769\_0001\_20107732\_GEN\_IS\_R2

## HOW TO INSTALL BATTERIES

1. Open the battery door with a screwdriver.
2. If used batteries are present, remove these batteries from the unit by pulling up on one end of each battery. DO NOT remove or install batteries using sharp or metal tools.
3. Install new batteries as shown in the polarity diagram (+/-) inside the battery compartment.
4. Replace battery door securely.
5. Check your local laws and regulations for correct recycling and/or battery disposal.

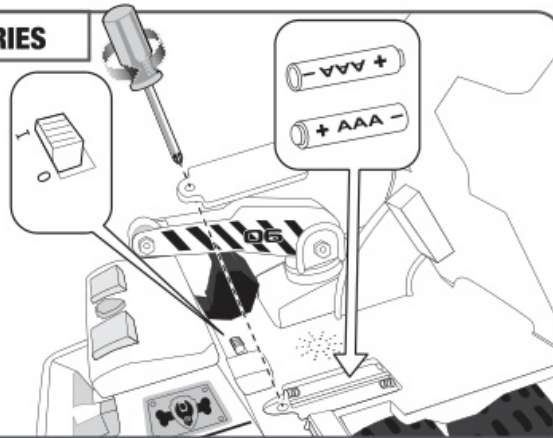

## LET'S PLAY

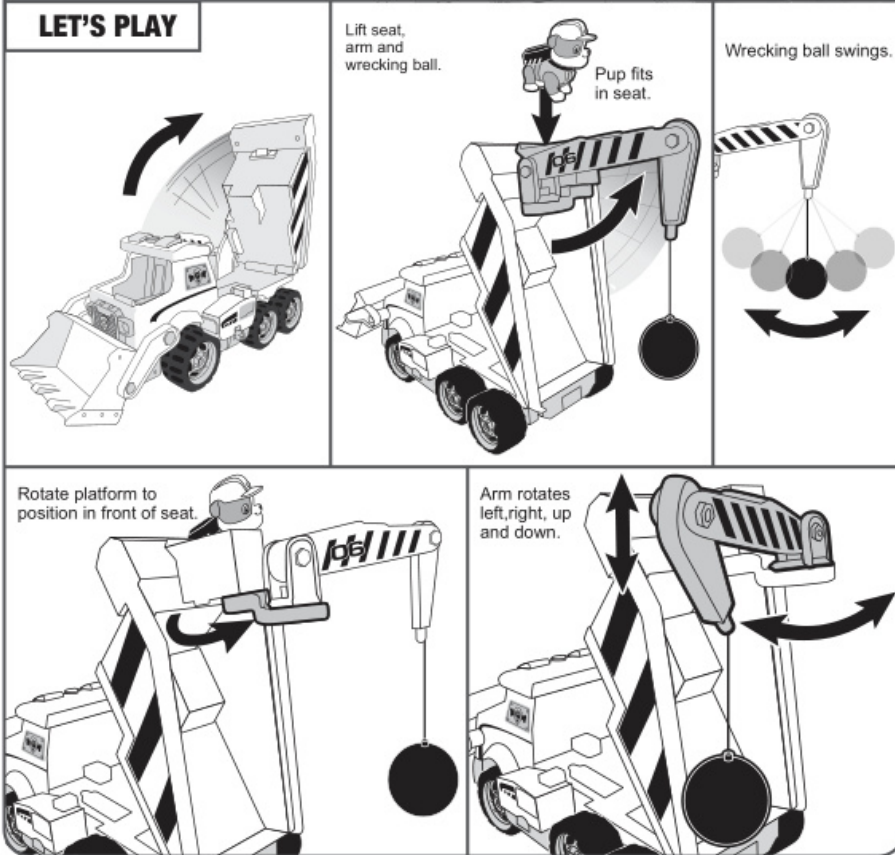

2

## RESET ARM & BALL

- 1 Rotate arm behind seat as shown.



- 2 Push dump bed down.

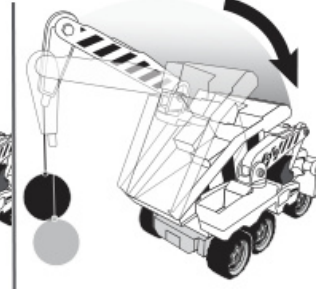

- 3 Place ball as shown and push down seat and arm

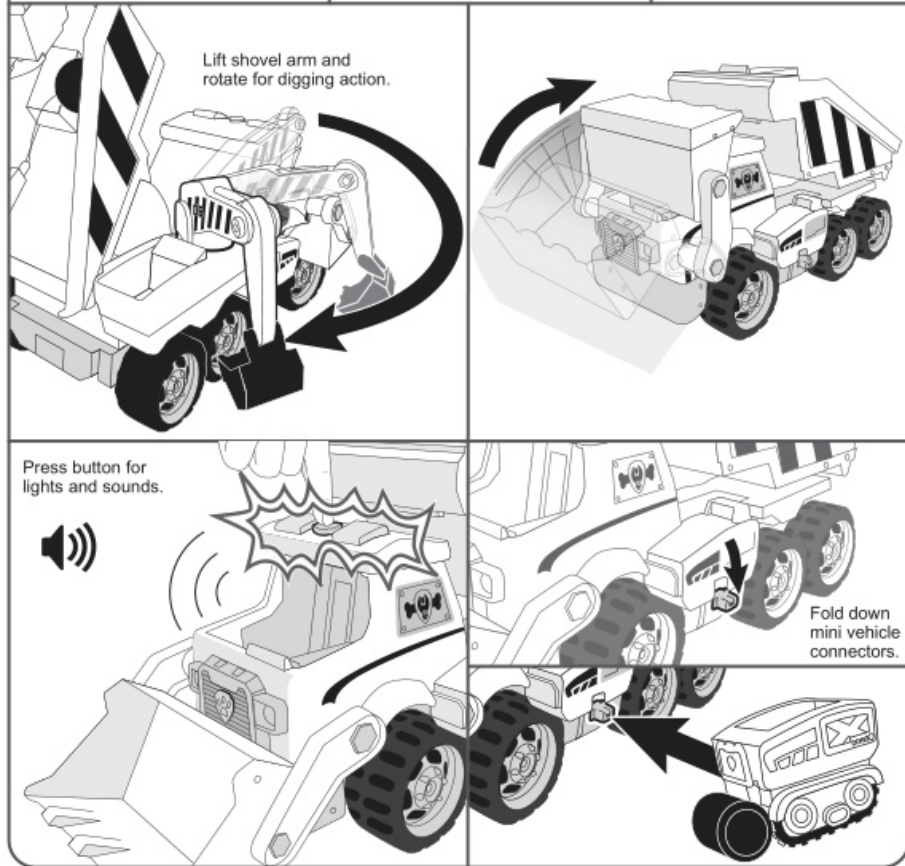
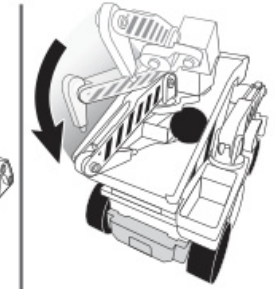

3