



NORTH AMERICA • AMÉRIQUE DU NORD
 1-800-622-8339, customercare@spinmaster.com
UK – 0800 206 1191, serviceuk@spinmaster.com
IRELAND – 1800 992 249
FRANCE – 0800 909 150, servicefr@spinmaster.com
AUSTRALIA – 1800 316 982, customercare@spinmaster.com

WWW.SPINMASTER.COM



Requires 3 x 1.5V AG13 (LR44) button cell batteries (INCLUDED). Batteries or battery packs must be recycled or disposed of properly. When this product has reached the end of its useful life, it should not be disposed of with other household waste. The Waste Electrical and Electronic Equipment Regulations require it to be separately collected so that it can be treated using the best available recovery and recycling techniques. This will minimize the impact on the environment and human health from soil and water contamination by any hazardous substances, decrease the resources required to make new products and avoid using up landfill space. Please do your part by keeping this product out of the municipal waste stream! The "wheelie bin" symbol means that it should be collected as "waste electrical and electronic equipment". You can return an old product to your retailer when you buy a similar new one. For other options, please contact your local council.

TROUBLESHOOTING!

If pressing the launch button is too difficult or doesn't function correctly, make sure the ramp is tight at ALL connection points top and sides.

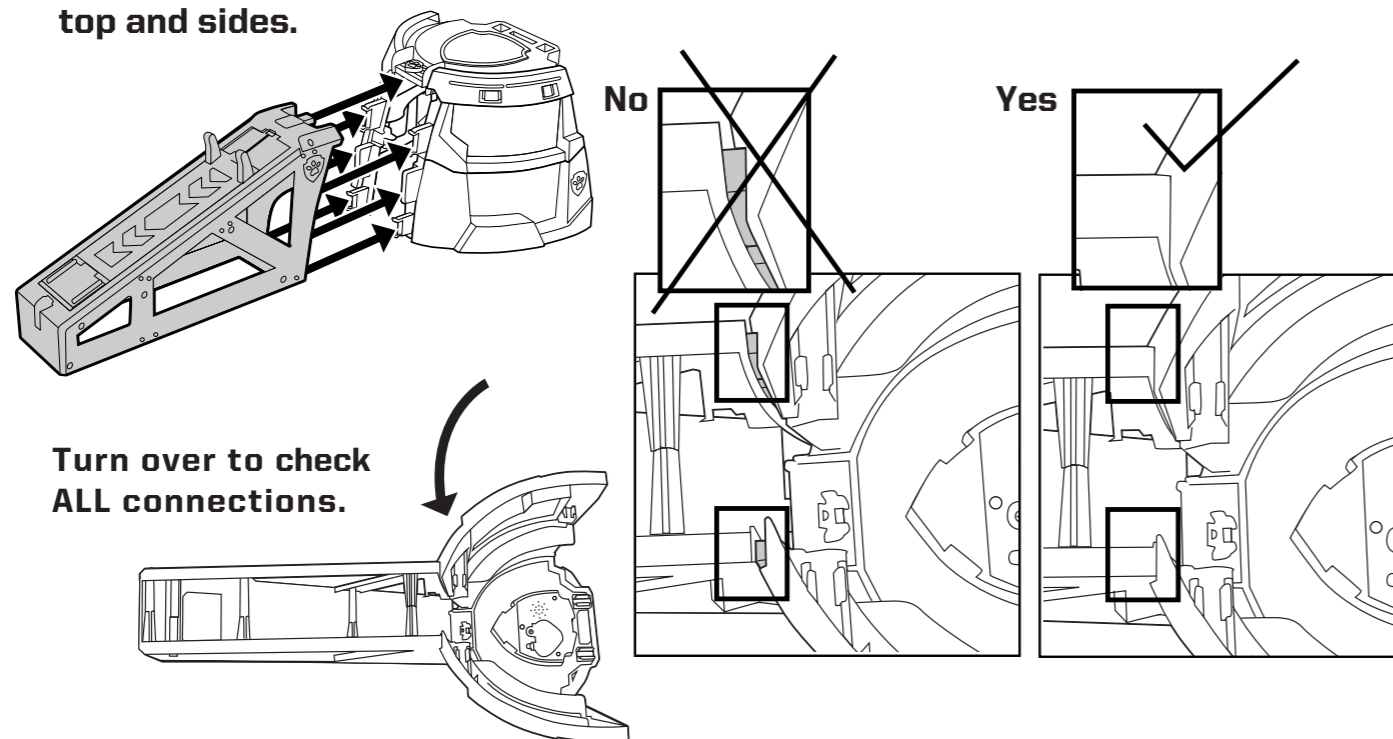

Retain this information, addresses and phone numbers for future reference.

©Spin Master Ltd.™PAW PATROL and all related titles, logos, characters; and SPIN MASTER logo are trademarks of Spin Master Ltd. Used under license. All rights reserved.

™Nickelodeon and all related titles and logos are trademarks of Viacom International Inc.

Spin Master Ltd. reserves the right to discontinue the <http://pawpatrol.com/MotoHQ> website at any time. MADE IN CHINA

Spin Master Ltd., 225 King Street West, Toronto ON M5V 3M2 Canada
 Imported into EU by Spin Master International B.V., Kingsfordweg 151, 1043 GR Amsterdam, NL
 Imported by Spin Master Australia Pty Ltd, Suite 101, Level 1, 18-24 Chandos Street, St Leonards, NSW 2065; ☎ 1800 316 982
 Imported by Spin Master Toys UK Ltd, Secure Trust House, Boston Drive, Bourne End, Buckinghamshire, SL8 5YS, UK



T17720_0001_20129843_GEN_IS_R3_PAW_Moto HQ



INSTRUCTION GUIDE

3+

INSTRUCTIONAL VIDEOS AT
<http://pawpatrol.com/MotoHQ>

CONTENTS

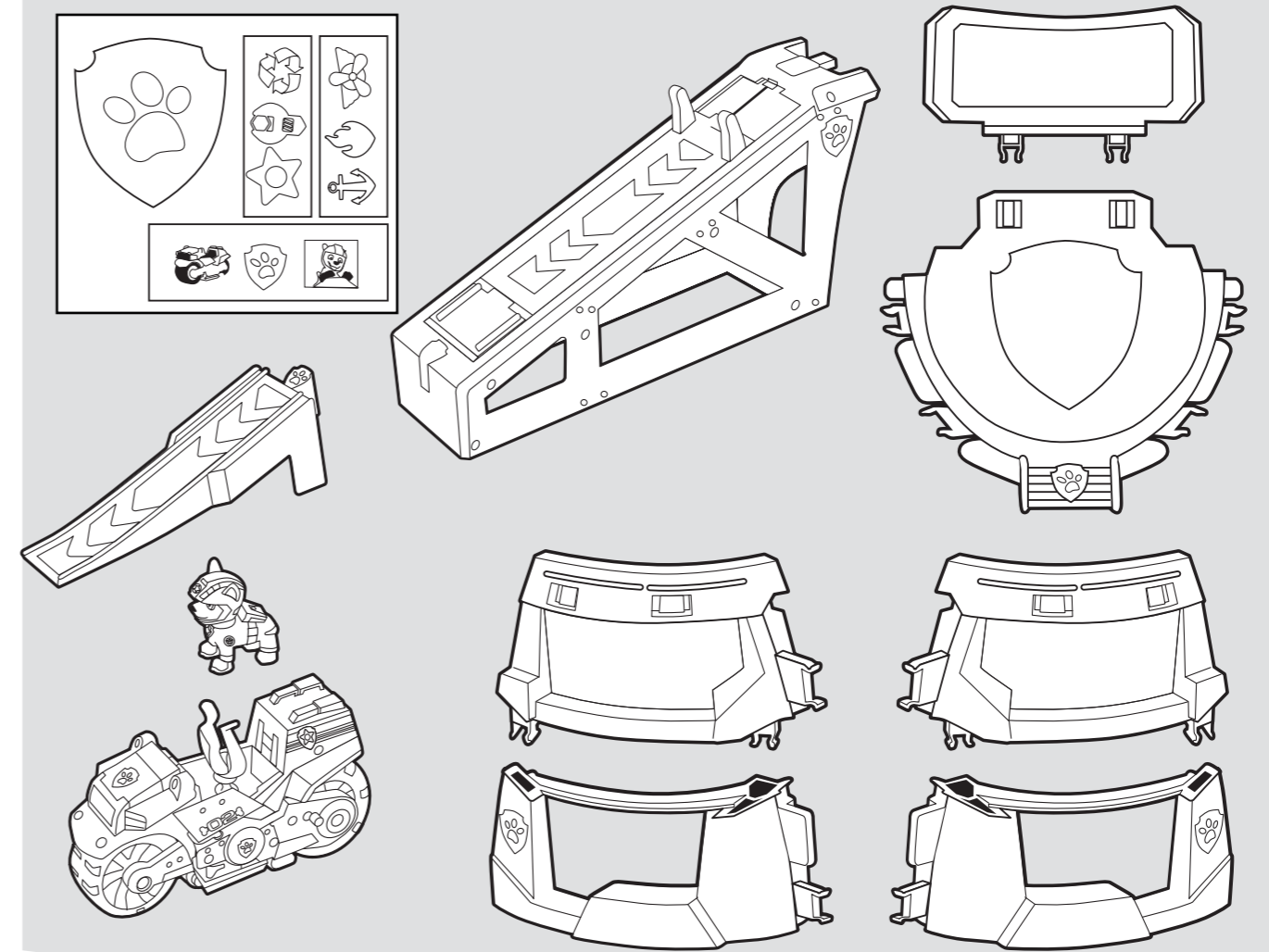

3x AG13 (LR44)
 1.5V / 1.5V
 INCLUDED

SOME ADULT ASSEMBLY REQUIRED.

⚠ **WARNING: CHOKING HAZARD** – Small parts. Not suitable for children under three years.



MOTO HQ™



BATTERY REMOVAL AND INSTALLATION INSTRUCTIONS

Ⓢ **HOW TO INSTALL BATTERIES:** 1. Open the battery door with a screwdriver. 2. If used batteries are present, remove these batteries from the unit by pulling up on one end of each battery. DO NOT remove or install batteries using sharp or metal tools. 3. Install new batteries as shown in the polarity diagram (+/-) inside the battery compartment. 4. Replace battery door securely. 5. Check your local laws and regulations for correct recycling and/or battery disposal.

⚠ **WARNING: KEEP BATTERIES OUT OF REACH OF CHILDREN.** This product contains a Button or Coin Cell Battery. A swallowed Button or Coin Cell Battery can cause internal chemical burns in as little as two hours and lead to death due to chemical burns and potential perforation of the esophagus. Dispose of used batteries immediately and safely. Used batteries can still be dangerous. Keep new and used batteries away from children. If you think batteries might have been swallowed or placed inside any part of the body, seek immediate medical attention.

(AUSTRALIAN RESIDENTS ONLY) If you suspect your child has swallowed or inserted a button battery immediately call the 24-hour Poisons Information Centre on 13 11 26 for fast, expert advice. Examine devices to make sure the battery compartment is correctly secured, e.g., that the screw or other mechanical fastener is tightened. Do not use if compartment is not secure. Tell others about the risk associated with button batteries and how to keep their children safe.

BATTERY SAFETY INFORMATION: Batteries are small objects. Replacement of batteries must be done by adults. Follow the polarity (+/-) diagram in the battery compartment. Promptly remove dead batteries from the toy. Dispose of used batteries properly. Remove batteries for prolonged storage. Only batteries of the same or equivalent type as recommended are to be used. DO NOT incinerate used batteries. DO NOT dispose of batteries in fire, as batteries may explode or leak. DO NOT mix old and new batteries or types of batteries (i.e. alkaline/standard/rechargeable). Using rechargeable batteries is not recommended due to possible reduced performance. Rechargeable batteries are only to be charged under adult supervision. Replaceable-rechargeable batteries are to be removed from the toy before being charged. DO NOT recharge non-rechargeable batteries. DO NOT short-circuit the supply terminals.

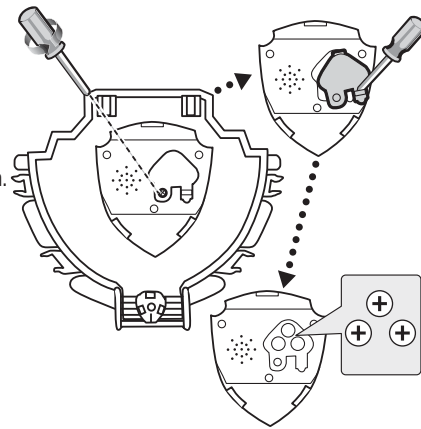

ASSEMBLY Follow step x step order and push all parts firmly together until they click.

1 Match symbols on parts.

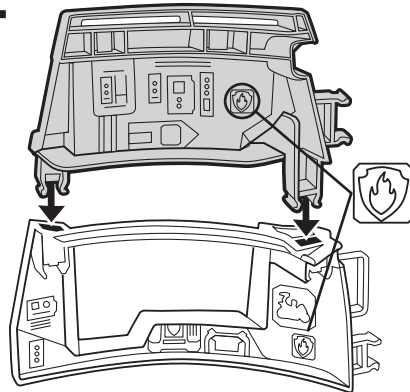

2 Match symbols on parts.

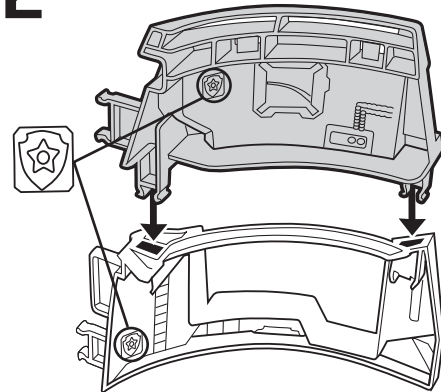

3

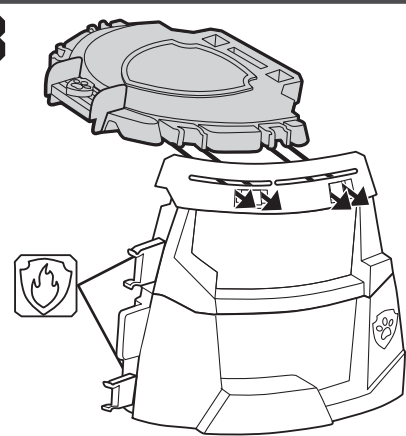

4

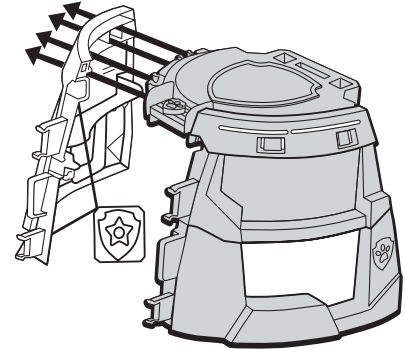

5 Firmly push parts together at ALL connection points on top and sides until tight and no gaps show

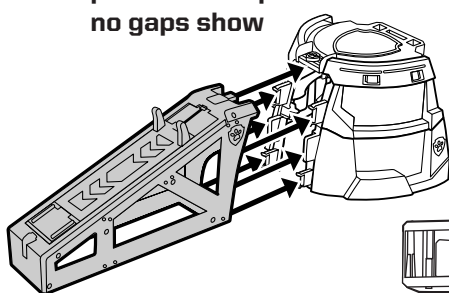

Turn over to check ALL connections.

Yes

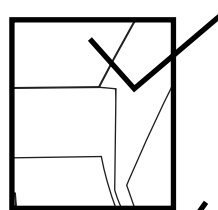

No

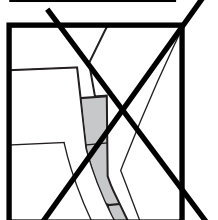

6

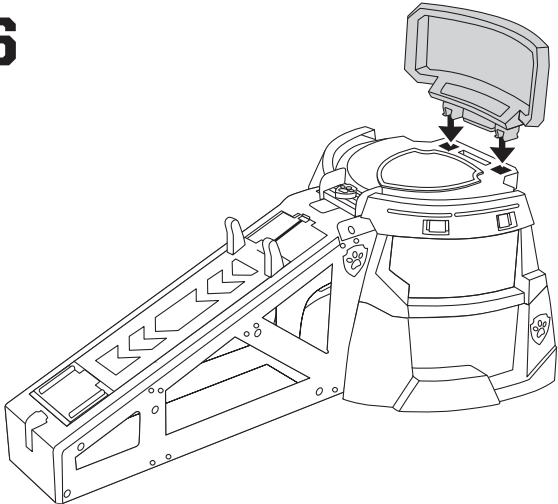

7

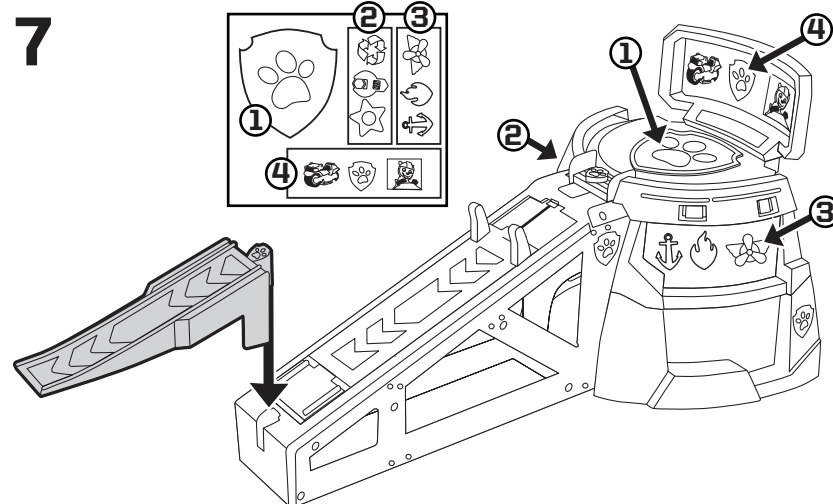

2

LET'S PLAY!

1 Press down on the large Paw Badge button to activate sounds.

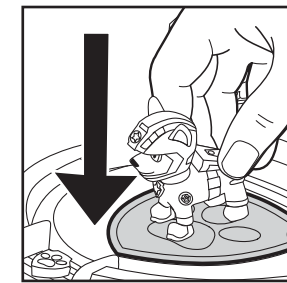

2

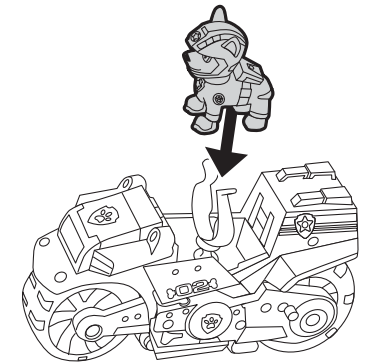

4 Push down on cycle while sliding platform up the ramp until it locks in place.

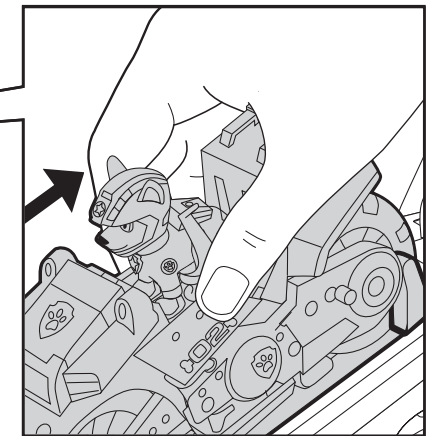
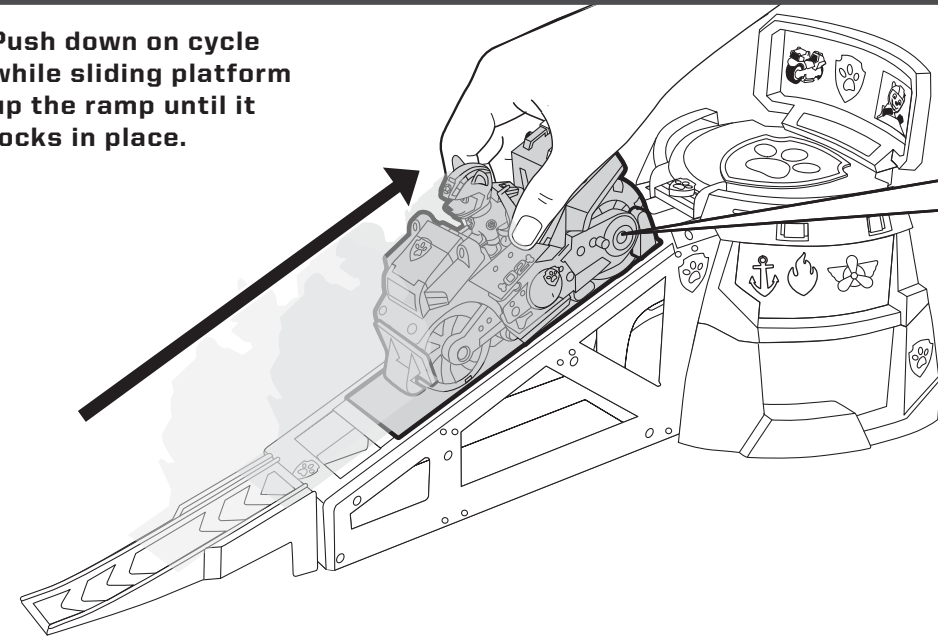

5 Push down on the small Paw Badge button to launch cycle and to pop a wheelie.

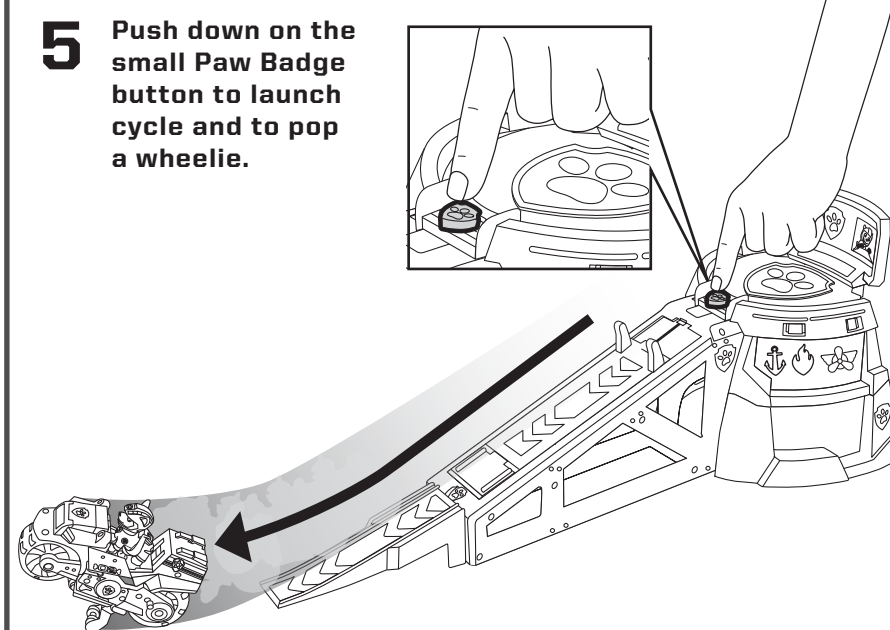

Reset cycle for vehicle play.

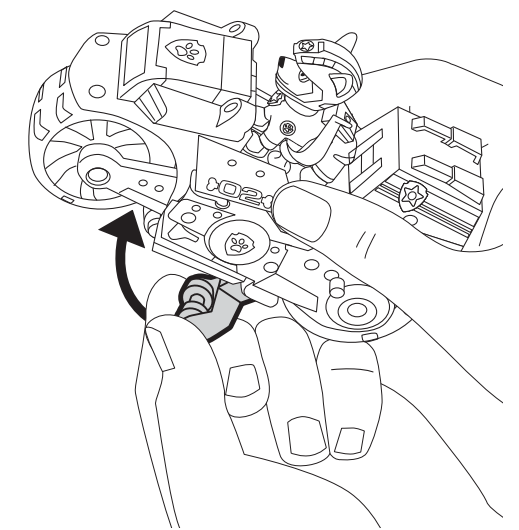

3